

GRP PROGRAM CONSTRUCTION PROGRESS



**GRP Review
Committee
Meeting
August 19, 2013**



**SJRA Board of
Directors
Meeting
August 22, 2013**

SURFACE WATER FACILITY CONSTRUCTION ADMINISTRATION

Project Data Thru 07/31/2013

Contracted Amount:	\$190,704,740.00
Change Orders:	\$ 0.00
Estimate to Complete:	\$190,704,740.00
Amount Invoiced:	\$ 39,361,472.28
Percent Complete:	20%
Completion Date:	June 2015



SURFACE WATER FACILITY CONSTRUCTION ADMINISTRATION

Project Data Thru 07/31/2013

Daily workforce: 260 workers

Concrete placed to date: 19,000 CYs (2,111 Trucks)

Average cost per day: \$161,000



Raw Water Intake and Pump Station

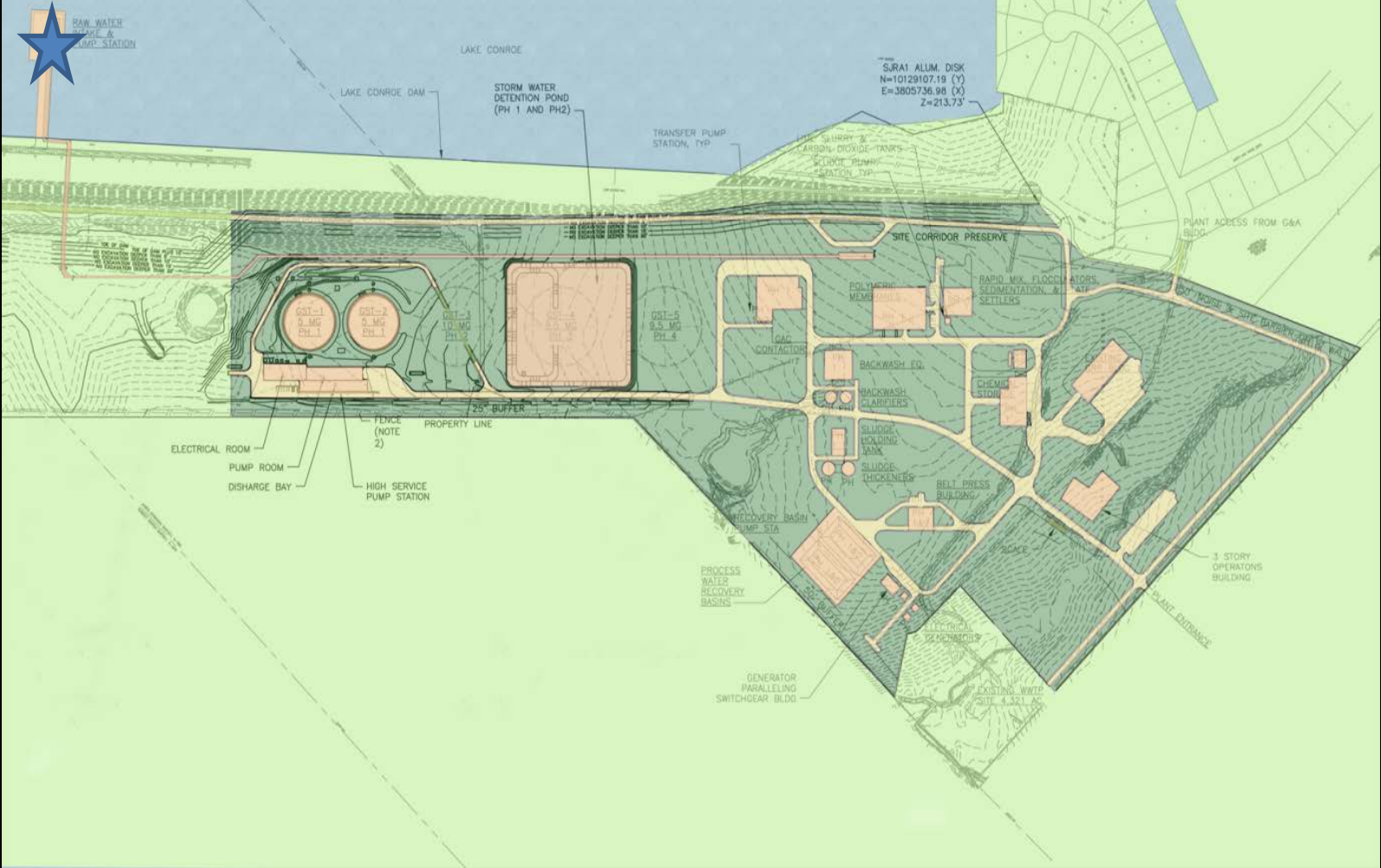



July Progress Photograph



Pump foundation complete

Ground Storage Tanks





July Progress Photograph



Wire winding complete



Interior tank view



High Service Pump Station



July Progress Photograph



Exterior masonry installation



**GAC
Contactors**



RAW WATER
INTAKE &
PUMP STATION

LAKE CONROE

LAKE CONROE DAM

STORM WATER
DETENTION POND
(PH 1 AND PH2)

TRANSFER PUMP
STATION, TYP

SURF ALUM. DISK
N=10129107.19 (Y)
E=3805736.98 (X)
Z=213.73'

LIQ. SUIPER &
CARBON DIOXIDE TANKS

PLANT ACCESS FROM GAA
BLDD

SITE CORRIDOR PRESERVE

GST-1
9.5 MG
PH. 1

GST-2
9.5 MG
PH. 1

GST-3
10.0 MG
PH. 2

GST-4
9.5 MG
PH. 1

GST-5
9.5 MG
PH. 4

GAC CONTACTORS

POLYMER
MEMBRANE

RAPID MIX FLOCCULATORS,
SEDIMENTATION, & TREAT
SETTLERS

200' WIDE & SITE BARRICADE BY WALL

ELECTRICAL ROOM

PUMP ROOM

DISCHARGE BAY

FENCE (NOTE
2)

PROPERTY LINE

25' BUFFER

HIGH SERVICE
PUMP STATION

RECOVERY BASIN
PUMP STA

PROCESS WATER
RECOVERY
BASINS

GENERATOR
PARALLELING
SWITCHGEAR BLDD

ELECTRICAL
GENCHIBOBS

EXISTING WWTP
SITE 4.321 AC

SPACE

3 STORY
OPERATORS
BUILDING

PLANT ENTRANCE



July Progress Photograph



Lower foundation and concrete wall installation at the GAC Building



Polymeric Membranes





July Progress Photograph



Foundation backfill complete at Membrane Building





July Progress Photograph



Installation of Pretreatment foundation rebar complete



**Electrical
Facilities**





Seal slab complete with grade beam installation underway at the Generator structure



Seal slab complete at Electrical Building and early stages of electrical rough-in



**Chemical
Facilities**





Select fill installation at the Chemical Facility



Operations Building





Subgrade preparations at Operations Building

SURFACE WATER FACILITY CONSTRUCTION PROGRESS

Questions?



SURFACE WATER TRANSMISSION SYSTEM CONSTRUCTION PROGRESS

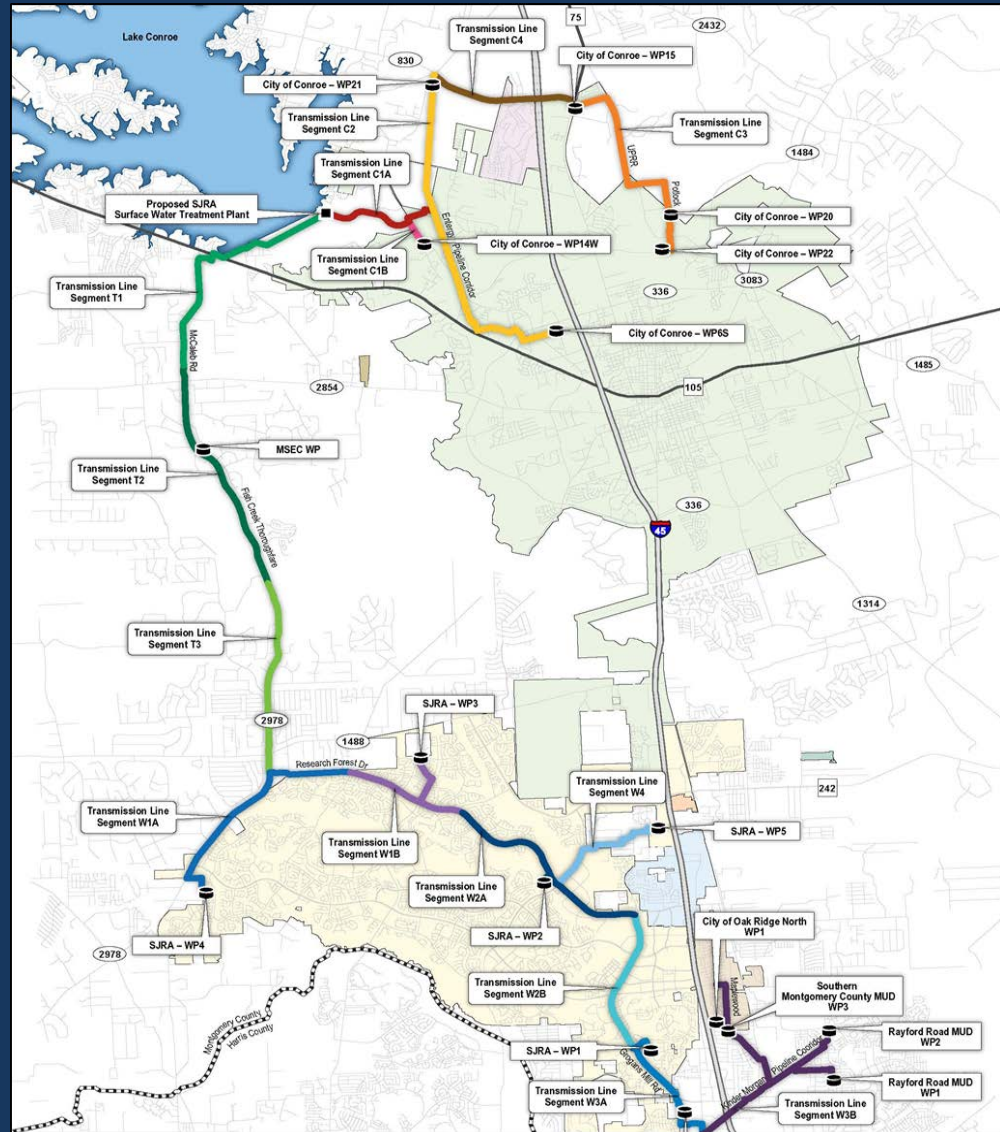

SURFACE WATER TRANSMISSION SYSTEM

"T" ROUTES – PROJECT DATA

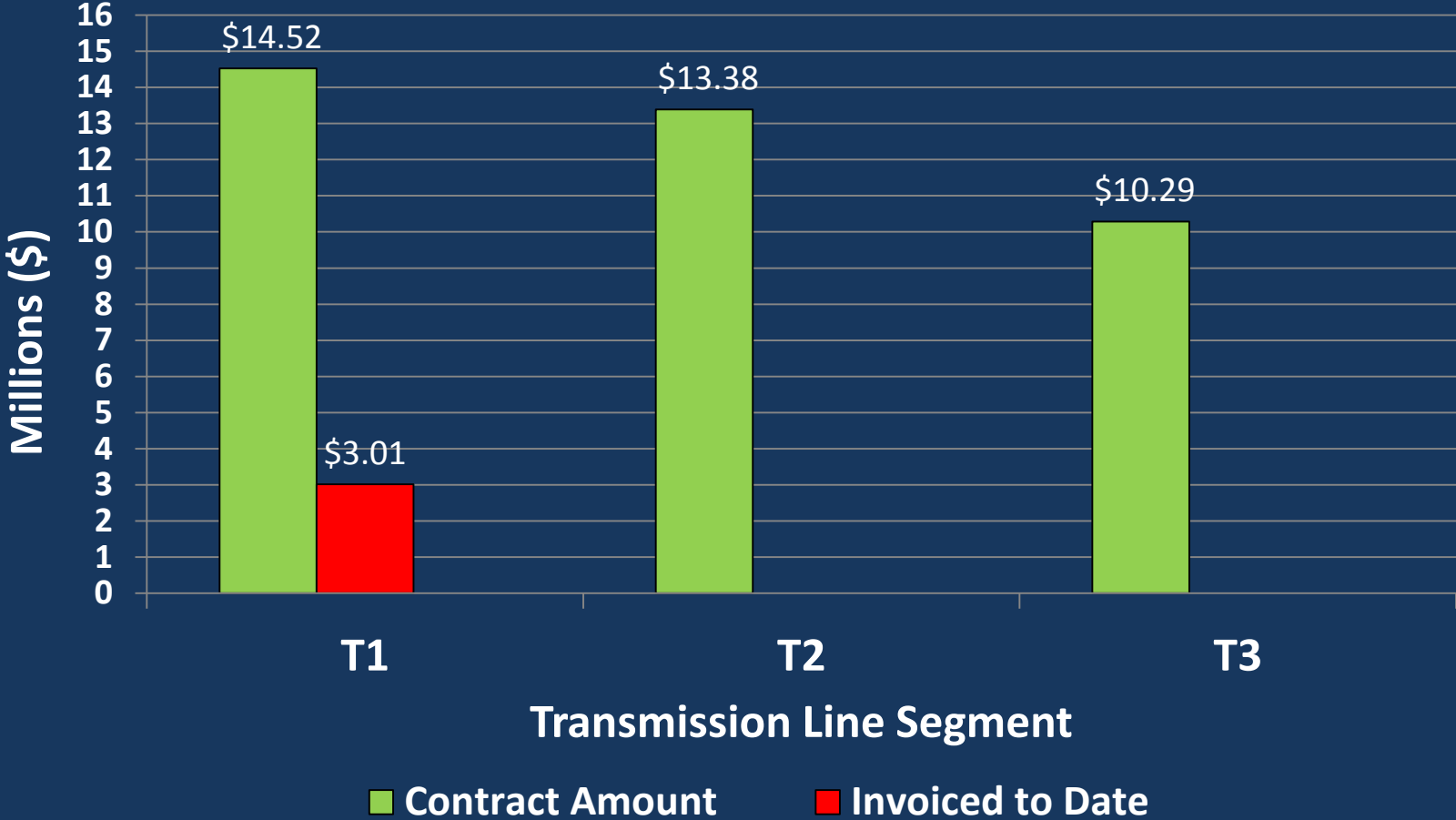

SURFACE WATER TRANSMISSION SYSTEM

“W” ROUTES – PROJECT DATA

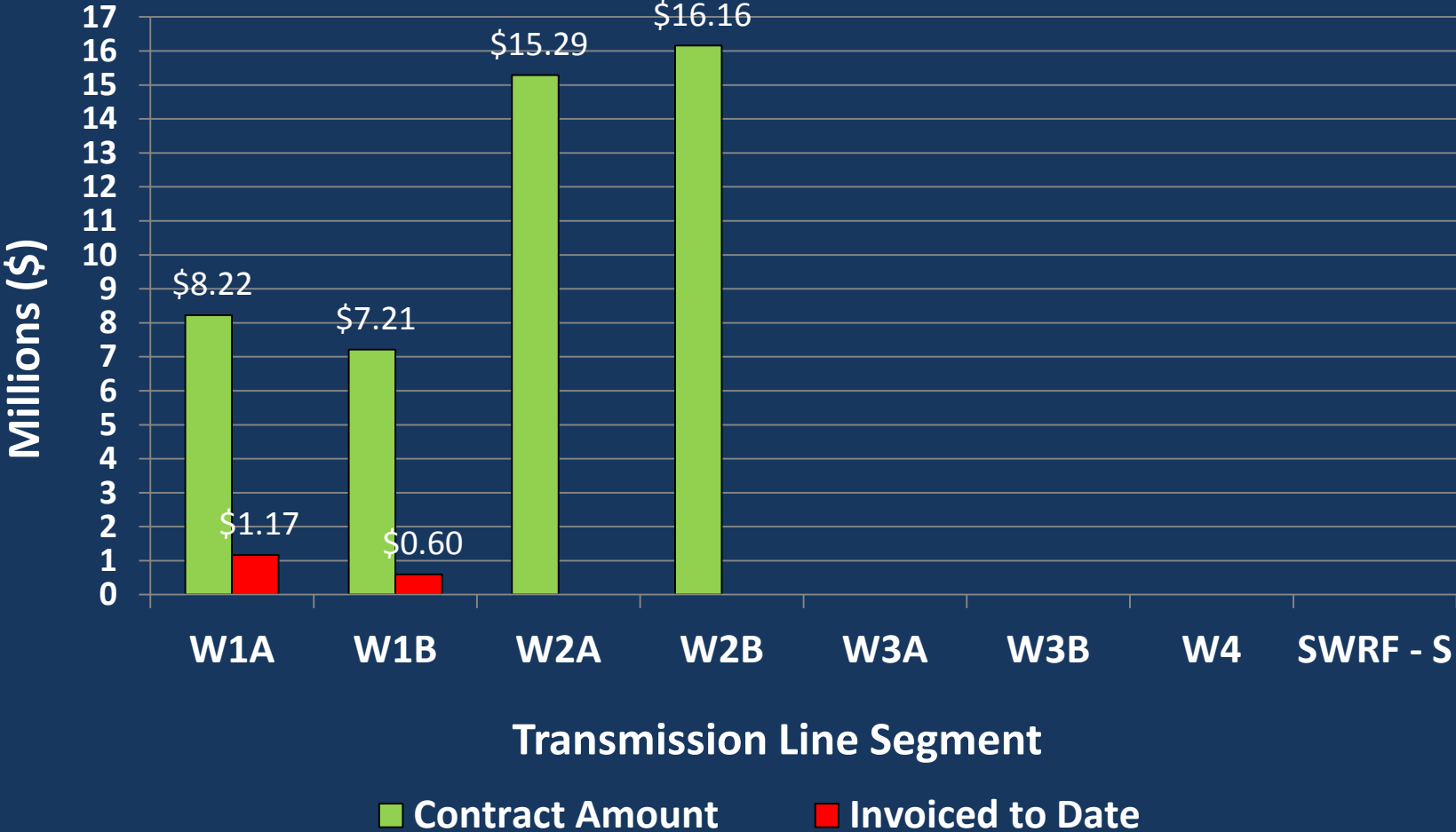

TRANSMISSION LINE SYSTEM CONSTRUCTION ADMINISTRATION

Project Data Thru 07/31/2013

Daily workforce:	120 workers
Piping installed to date:	11,000 LF
Average cost per day:	\$154,900





SJRA SURFACE WATER TREATMENT PLANT

Lake Conroe

Transmission Line Segment T1

105

2854

Line Segment T1

T1 Progress



Open cut installation of 60 inch line adjacent to G&A Building



Tunnel operation - G&A parking lot



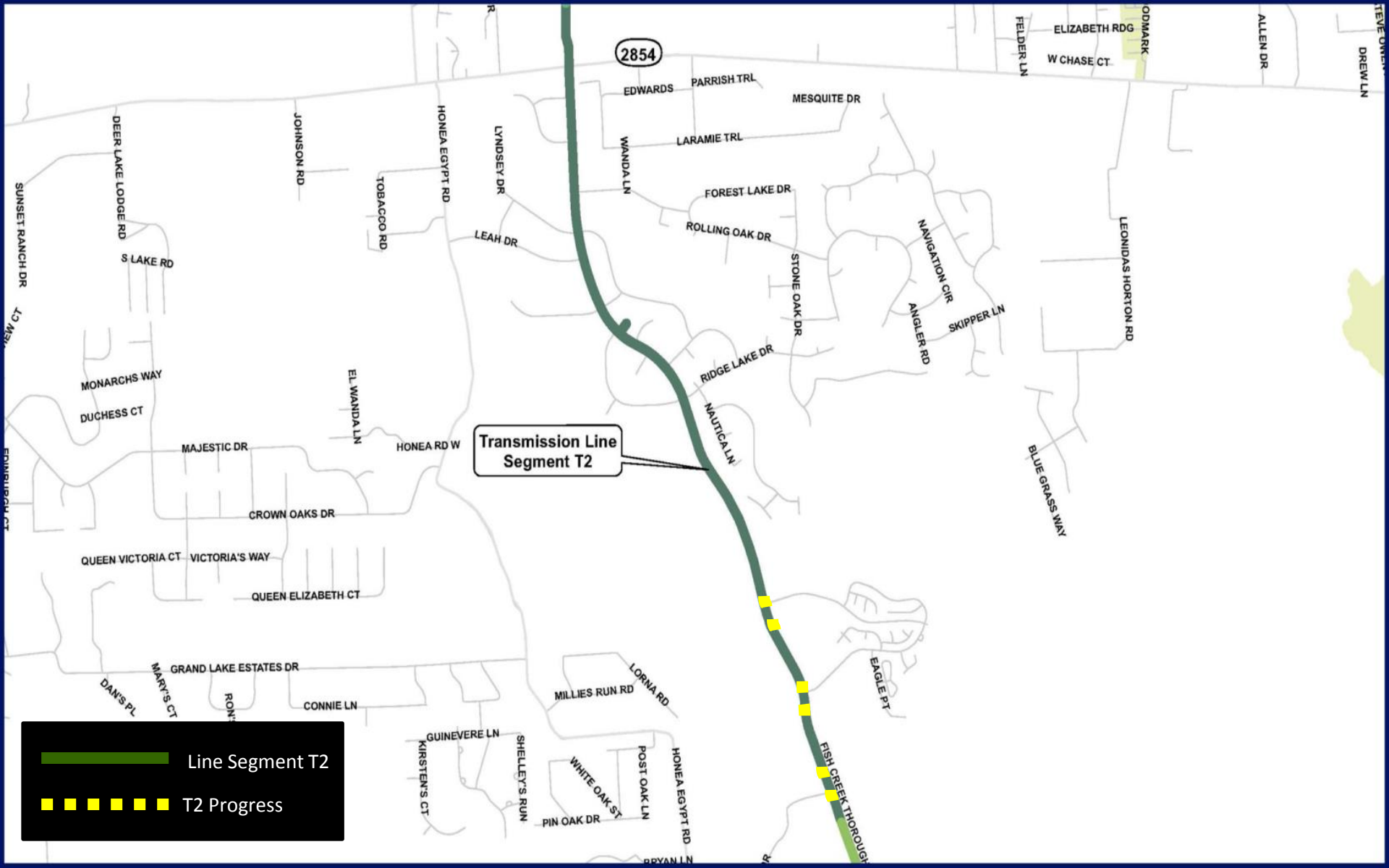

Interior view of tunnel – SH 105



2854

Transmission Line Segment T2

 Line Segment T2

 T2 Progress



ENSURING RELIABLE WATER SUPPLIES FOR MONTGOMERY COUNTY



DIRECTORS
LLOYD B. TISDALE
GARY MONTGOMERY
MARY L. RUMMELL
JOSEPH STUNJA
JOHN ECKSTRUM
MIKE BLEIER
FRED KOETTING
GENERAL MANAGER
JACE A. HOUSTON

**SEGMENT T2 60", 54" AND
12" WATER TRANSMISSION LINE**

INFORMATION: 936-588-1662
WWW.SJRA.NET/GRP

TEXAS STERLING CONSTRUCTION CO.
281-821-9091

Tunnel operation - Fish Creek at Mulligan Drive



Tunnel boring machine in operation



Steel casing for tunnel section



Jacking of steel casing



Transmission Line Segment W1A

Transmission Line Segment W1B

Transmission Line Segment W2A

Line Segment W1A

W1A Progress

1488

2978



Fusing 16 inch PVC Pipe – FM 2978



Water line installation along FM 2978





Tunnel operation under Research Forest at Kuykendahl Road



Staging of 20 inch PVC pipe along Kuykendahl Road extension



Open cut pipe installation at Kuykendahl Road extension

SCHEDULE OF REMAINING TRANSMISSION SYSTEM PROJECTS

Project Name	Proposal Opening	Board Action Date	Notice to Proceed
SWRF - South	07/18/13	08/22/13	09/09/13
Segment C3	07/24/13	09/26/13	10/14/13
Segment C4	08/06/13	09/26/13	10/15/13
SWRF - North	08/06/13	09/26/13	10/14/13
Segment C2	08/15/13	09/26/13	10/15/13
Segment W4	08/20/13	09/26/13	10/14/13
Segment C1B	09/03/13	10/31/13	11/18/13
Segment W3A	09/24/13	10/31/13	11/12/13
Segment W3B	11/13/13	12/12/13	01/06/14
Segment C1A	09/17/13	10/31/13	11/18/13
Standpipe	11/13/13	12/12/13	01/06/14

SURFACE WATER TRANSMISSION LINE CONSTRUCTION PROGRESS

QUESTIONS?

